

General Specifications

Product name		ScanSnap S1300	
Scanner type		ADF (Automatic Document Feeder), duplex scanning	
Scanning modes		Color, grayscale, monochrome, automatic (color / grayscale / monochrome detection)	
Image sensor		CIS (Contact Image Sensor) x 2	
Light source		3 Color LED (Red/Green/Blue)	
Optical resolution		600dpi	
Scanning speed*1 (A4 portrait)	AC adapter	Auto mode*2	Simplex, duplex 4ppm
		Normal mode	Color / grayscale 150dpi, monochrome 300dpi, simplex, duplex 8ppm
		Better mode	Color / grayscale 200dpi, monochrome 400dpi, simplex, duplex 6ppm
		Best mode	Color / grayscale 300dpi, monochrome 600dpi, simplex, duplex 4ppm
		Excellent mode	Color / grayscale 600dpi, monochrome 1,200dpi, simplex, duplex 0.5ppm
	USB bus powered*3	Auto mode*2	Simplex, duplex, 2ppm
		Normal mode	Color / grayscale 150dpi, monochrome 300dpi, simplex, duplex 4ppm
		Better mode	Color / grayscale 200dpi, monochrome 400dpi, simplex, duplex 3ppm
		Best mode	Color / grayscale 300dpi, monochrome 600dpi, simplex, duplex 2ppm
		Excellent mode	Color / grayscale 600dpi, monochrome 1,200dpi, simplex, duplex 0.5ppm
Document size	Normal mode	A4, A5, A6, B5, B6, Business card, Post card, Letter, Legal and Custom sizes (Max: 216 x 360mm (8.5 x 14.17in.), Min: 50.8 x 50.8mm (2 x 2in.)) / Automatically recognizes document size	
	Long paper scanning*4	863mm (34in.)	
Paper weight (Thickness)		64 to 104.7g/m ² (17.1 to 28.0lb)	
Paper chute capacity*5		Maximum 10 sheets (A4, 80g/m ² or 20lb)	
Interface		USB2.0 (USB1.1 Compatible)	
Power requirement	AC adapter	AC 100 to 240V, 50 / 60 Hz	
	USB bus power	5V/1A (0.5A x 2port)	
Power consumption	Power cable connection	During operation : 9W or less , During sleep mode : 3.2W or less	
	USB bus power cable connection	During operation : 5W or less , During sleep mode : 2W or less	
Operation environment		Temperature : 5 to 35°C (41 to 95°F) Relative humidity : 20 to 80% (Non-condensing)	
Dimensions (W x D x H)*6		284 x 99 x 77mm (11.18 x 3.90 x 3.03in.)	
Device weight		1.4kg (3.08lb)	
Environmental compliance*7		ENERGY STAR® compliant / RoHS	
Multi-feed detection		Length check	
Driver		Specific driver ● Windows : Does not support TWAIN / ISIS™ ● Mac OS : Does not support TWAIN	

*1 Scanning speeds may vary due to the system environment used. *2 Documents measuring approximately 148mm in length or less are scanned in "Best mode", while other documents are scanned in "Better mode". *3 When using the USB bus power cable, the personal computer must have two USB ports : one for power feeding, the other for USB cable connection. *4 ScanSnap S1300 is capable of scanning documents that exceed A4 size in length. It supports the scanning of longer documents in all modes, except for "Excellent mode". *5 Maximum capacity varies, depending upon paper weight. *6 When chuter is closed. *7 PFU Limited, a Fujitsu company, has determined that this product meets RoHS requirements (2002/95/EC).

Software

	Windows®	Mac OS
Driver*1	ScanSnap Manager V5.1 (TWAIN / ISIS™ not supported)	ScanSnap Manager V3.1 (TWAIN not supported)
Applications	ScanSnap Organizer V4.1	-
	CardMinder™ V4.1	-
	-	Cardiris™ 3.6 for ScanSnap
	ABBYY FineReader for ScanSnap™ 4.1	ABBYY FineReader for ScanSnap™ 4.1
	Scan to Microsoft SharePoint 3.3.5	-

*1 TWAIN or ISIS™ applications cannot be used directly

Options

Description	Model Number	Remarks
ScanSnap S300 Soft Case	PA03541-0004	Intended for ScanSnap S1300, S300, S300M and included items

*1 This product has been especially designed for storing and carrying ScanSnap S1300 / S300 / S300M. Please note that this product is not guaranteed to withstand damage by excessive shock or external pressure.

This scanner is designed to digitize materials that can be reproduced lawfully, in accordance with applicable copyright regulations and other laws. ScanSnap users are responsible for how they use this scanner. It is imperative that ScanSnap users comply with all applicable local rules and laws, including, without limitation, copyright laws when using this scanner.

* Microsoft, Windows, Windows Vista, PowerPoint and SharePoint are either registered trademarks or trademarks of Microsoft Corporation in the United States and/or other countries.
* Word and Excel are the products of Microsoft Corporation in the United States.
* Mac, Mac OS, Mac logo and iPhoto are trademarks of Apple Inc.
* Adobe, the Adobe logo, Acrobat, and Adobe Reader are either registered trademarks or tradenames of Adobe Systems Incorporated in the United States and/or other countries.
* Intel, Pentium, and Intel Core are trademarks or registered trademarks of Intel Corporation in the United States and other countries.
* ISIS™ is a registered trademark of EMC Corporation in the United States.
* ABBYY™ FineReader™ 7.X/8.X/9.X Engine, © ABBYY 2009. OCR by ABBYY. All rights reserved. ABBYY, FineReader are trademarks of ABBYY.
* Cardiris is a trademark of I.R.I.S.
* ScanSnap, ScanSnap logo, and CardMinder are the trademarks of PFU LIMITED.
* Other company names and product names are the trademarks or registered trademarks of the respective companies.

For more ScanSnap related information, visit our web site at : <http://scansnap.fujitsu.com/>

Safety Precautions	
Be sure to carefully read all safety precautions prior to using this product and use this device as instructed.	Do not place this device in wet, moist, steamy, dusty or oily areas. Using this product under such conditions may result in electrical shock, fire or damage to this product.

--

Specifications are subject to change notice.

ScanSnap S1300 System Requirements

Windows®

Compatible operating systems	Windows® 7 (32bit / 64bit)	Windows Vista™ (32bit / 64bit)	Windows® XP (32bit)	Windows® 2000 Professional
Driver / Applications*1	ScanSnap Manager V5.1	Supported	Supported	Supported*3
	ScanSnap Organizer V4.1*2	Supported	Supported	Supported*3
	CardMinder™ V4.1	Supported	Supported	Supported*3
	ABBYY FineReader for ScanSnap™ 4.1	Supported	Supported	Supported*3
	Scan to Microsoft SharePoint 3.3.5	Supported	Supported	Supported*3
Hardware requirements	CPU*5	Intel® Pentium® 4 1.8GHz or higher (recommended: Intel® Core™2 Duo 2.2GHz or higher)		
	Memory capacity*5	64bit : 2GB or more 32bit : 1GB or more		
	Display	800 x 600 pixels or more, High color (16-bit) or more		
	Disk capacity	2,197MB free hard disc space for installation		
	DVD-ROM drive	Required for installation		
	USB port*5	USB 2.0 / USB 1.1		

*1 These products only support Microsoft Windows®. *2 Windows® Desktop Search (WDS) can be used with Windows® 7, Windows Vista™ or Windows® XP. Adobe® Acrobat® 7.0 or later (not included) is required in order to use the Adobe® Acrobat® search feature. Windows Vista™ users must apply the Adobe® Acrobat® update for Windows Vista™ before using the search feature. *3 Service Pack 2 or later required. *4 Service Pack 4 or later required. *5 Scanning speeds may drop if recommended CPU, memory capacity and USB 1.1 requirements are not met.

Mac OS

Compatible operating systems	Mac OS X v10.6	Mac OS X v10.5	Mac OS X v10.4
Driver / Applications*1	ScanSnap Manager V3.1	Supported	Supported
	Cardiris™ 3.6 for ScanSnap	Supported*3	Supported
	ABBYY FineReader for ScanSnap™ 4.1	Supported	Supported
Hardware requirements	CPU*2	Intel® Core™ Duo 1.83GHz or higher (recommended : Intel® Core™ 2 Duo 2.4GHz or higher)	Intel® Core™ Duo 1.83GHz or higher (recommended : Intel® Core™ 2 Duo 2.4GHz or higher)
	Memory capacity*2	1GB or more	512MB or more (recommended : 1GB or more)
	Display	1024 x 768 pixels or more	
	Disk capacity	1,320MB free hard disc space for installation	
	DVD-ROM drive	Required for installation	
	USB port*2	USB 2.0 / USB 1.1	

*1 These products only support Mac OS. *2 Scanning speeds may drop if recommended CPU, memory capacity and USB 1.1 requirements are not met. *3 Requires Rosetta.

Rack2-File V5.0 System Requirements (Windows® Only)

Compatible operating systems	Windows® 7 (32bit / 64bit)	Windows Vista™ (32bit / 64bit)	Windows® XP (32bit)	Windows® 2000 Professional
Hardware requirements	CPU	Intel® Pentium® 4 1.8GHz or higher	Intel® Pentium® III 600MHz or higher	
	Memory capacity	64bit : 2GB or more 32bit : 1GB or more	512MB or more (recommended : 1GB or more)	256MB or more (recommended : 512MB or more)
	Display	800 x 600 pixels or more, High color (16-bit) or more		
	Disk capacity	System drive : 10MB or more disc space Instration drive : 450MB or more disc space* *Additional space is required for the data created by Rack2-File		

Included items

- AC cable
- USB bus power cable
- Getting started
- Set-up DVD-ROM
- AC adapter
- USB cable (2.0m)
- Safety Precautions

Consumables

Description	Model Number	Remarks
Pick Roller*	PA03541-0001	Lifetime: Every 100,000 sheets or one year.
Pad Assy*	PA03541-0002	Lifetime: Every 10,000 sheets or one year.
Cleaner F1	PA03950-0352	100ml bottle Used to clean Pick Rollers and Pad Assy
Cleaning wipe	PA03950-0419	1 pack(24sheets) Used to clean Pick Rollers and Pad Assy

* These recommended lifetimes are for 80g/m² (20lb) A4 sized documents. Therefore, appropriate replacement lifetimes may vary for other document types.

POWERED BY ABBYY
FineReader
OCR
FineReader
OCR

ABBYY™ FineReader™ 7.X/8.X/9.X Engine, © ABBYY 2009. OCR by ABBYY. All rights reserved. ABBYY, FineReader are trademarks of ABBYY.

ENERGY STAR

PFU Limited, a Fujitsu company, has determined that this product meets the ENERGY STAR® guidelines for energy efficiency. ENERGY STAR® is a registered trademark of the United States.

Mac Universal



Compact, easy to use
"one touch" scanning!

NEW

Compact Color Duplex Scanner
ScanSnap
Color Image Scanner
S1300

Visit the ScanSnap web site for ordering and purchasing information <http://scansnap.fujitsu.com/>

Easily digitizes your documents! Perfect for home or office use!

A must have for the paperless era!

ScanSnap
Color Image Scanner
S1300



Easy to use "one touch" scanning!

Compatible with both Windows® and Mac operating systems **NEW**

The versatile S1300 can scan your important documents under Windows® or Mac operating systems with equal ease. This opens more possibilities to the scanning tasks you can do at the office.

The following features are found only on Windows®

- Compression type : PDF (High compression)
- Sheet setting : Front side up
- Password protection of the file (PDF file)
- ABBYY Scan to PowerPoint
- File automatic distribution function by key word
- Intelligent Cropping
- Linking with Microsoft® Office SharePoint®

Just press "Scan" and see documents quickly digitized the way you want them

Simply place your paper documents into the ADF paper chute press the "Scan" button and the S1300 handle the rest, including paper size detection, de-skewing, image orientation correction and blank page removal. The result - digital images made the way you like them.

Blank page removal

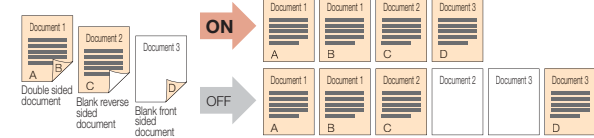

Auto deskew and auto orientation



Instantly creates digitized data for later reference

The S1300 automatically converts scanned data into searchable PDF files that let you quickly and easily find the scanned data that you are looking for with keyword searches.

Holds up to 10 A4 sheets at a time

The S1300 is able to scan up to 8 double sided color pages (16 images) per minute.



Compact scanner

At half the size of other ScanSnap scanners, the S1300 is designed to be the smaller ADF scanner. The S1300 is compact enough to carry around and you will never have to worry about finding a spot to place it.

Able to run on USB bus power

Just hook the S1300 up to a personal computer USB connector* to easily use it when an AC power source is not available.

* USB2.0/USB1.1
Connector type: USB Mini-Btype

*When using the USB bus power cable, the personal computer must have two USB ports : one for power feeding, the other for USB cable connection.



The ScanSnap S300 Soft Case (Optional)

This product has been especially designed for storing and carrying ScanSnap S1300/S300/S300M.

*Please note that this product is not guaranteed to withstand damage by excessive shock or external pressure.



S1300's "Quick Menu" facilitates speedy flexible use

Users just choose what they want to do from the Quick Menu, which appears after a document has been scanned. S1300's Quick Menu is perfect for everyone, even the complete novice!

Quick Menu for Windows® Users



Quick Menu for Mac OS Users

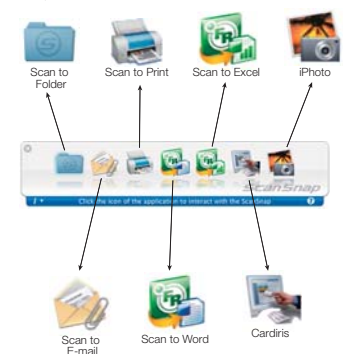

STEP 1
Set

STEP 2
One touch

"Intelligent features" take the labor out of scanning tasks **NEW**

The S1300 facilitates "simple & easy & speedy" PDF generation with the following one touch activated automatic settings and automatic image correction functions:

Intelligent Indexing [Windows® / Mac OS]

This S1300 feature automatically takes highlighted words or sections of documents and converts them into searchable keywords after OCR processing in order to make your PDF file searches easier and faster.

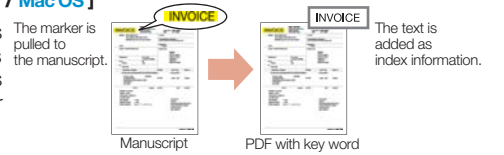

Intelligent Automatic Color Detection [Windows® / Mac OS]

The S1300 features Automatic Color Detection Function which now employs an advanced grayscale processing so that your black & white photos and diagrams become digitized in even better image quality than before.



Intelligent Cropping [Windows®]

This S1300 feature enables users to easily "cut out" digitized copies of newspaper and magazine articles that they have outlined on the original paper document with a highlight pen.

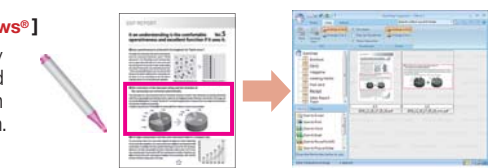

Bundled PDF management & search software **ScanSnap Organizer V4.1 [Windows®]**

S1300 linking with Microsoft® Office SharePoint® Server [Windows®]

Bring greater utility to your documents and vastly improve workplace efficiency by sharing and managing documents in a networked environment using the S1300's Microsoft® Office SharePoint® Server linking function.

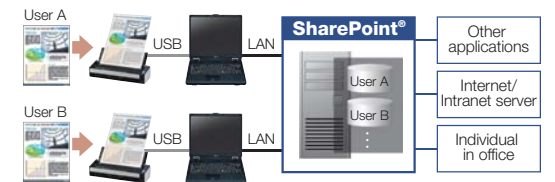

Efficiently organizes business card information

Bundled Business card scanning software **CardMinder™ V4.1 [Windows®]**

- Scans large volumes of business cards into digital business card holders.
- Enables users to enter scanned business card data into Excel, Windows Mail and other databases for future reference.

Bundled Business card scanning software **Cardiris™ 3.6 for ScanSnap [Mac OS]**

- Scans large volumes of business cards into digital business card holders.
- Enables users to enter scanned business card data into Address Book and other databases for future reference.

Generates Microsoft® Word, Excel*1, PowerPoint® files

Bundled Top-class OCR engine **ABBYY FineReader for ScanSnap™ 4.1 [Windows®]**
ABBYY FineReader for ScanSnap™ 4.1 [Mac OS]

Editable images can be created by scanning directly to Microsoft® Word, Excel*1 and PowerPoint files.*2
*1 Only Microsoft® Word and Excel are available for Mac OS. *2 Generated images and text may vary from the original.

ScanSnap S1300 / Rack2-Filer V5.0 Bundled Model [Windows® Only]

- Supports uniform management of S1300 generated images as well as other digitized data
- Enables operators to directly save S1300 generated images into Rack2-Filer
- Enables users to save digital data in realistic looking book cases and files in the same way they would with paper-based information.
- Loaded with many editing features and a function that enables users to "flip" through Rack2-Filer files in the same way they would flip through regular files.

Note: Rack2-Filer can also be purchased as a stand alone product.

